

SOWA

METALWORKING SOLUTIONS



Canadians
Supporting
Canadians

CADIS17

Pricing valid from January 1 to March 31 2012



3 FLUTE SQUARE END 35° HELIX CARBIDE ENDMILLS FOR ALUMINUM

- Special geometry allows for high chip loads and feed rates.
- 3 flute design excellent for slotting and profiling at high speeds.
- Made from premium submicron grain carbide.
- Cutting diameter tolerance +.000/-.002

SPECIAL NET PRICING!!



Regular Length

Cutting Dia. (in.)	Shank Dia. (in.)	Flute Length (in.)	Overall Length (in.)	Corner Radius	Bright Finish Code No.	SALE \$	TiCN Coated Code No.	SALE \$
1/8	1/8	3/8	1-1/2	0.005	153-150	10.20	153-044	12.15
3/16	3/16	5/8	2	0.005	153-152	13.80	153-046	16.43
1/4	1/4	3/4	2-1/2	0.005	153-154	18.45	153-048	22.05
5/16	5/16	13/16	2-1/2	0.005	153-156	23.93	153-050	29.33
3/8	3/8	1	2-1/2	0.005	153-158	27.53	153-052	32.78
7/16	7/16	1	2-3/4	0.005	153-160	37.35	153-054	46.05
1/2	1/2	1-1/4	3	0.005	153-162	46.13	153-056	52.95
5/8	5/8	1-5/8	3-1/2	0.005	153-164	83.48	153-058	95.70
3/4	3/4	1-5/8	4	0.005	153-166	126.23	153-060	140.55
1	1	1-1/2	4	0.005	153-168	193.05	153-062	213.83

Long Length

Cutting Dia. (in.)	Shank Dia. (in.)	Flute Length (in.)	Overall Length (in.)	Corner Radius	Bright Finish Code No.	SALE \$	TiCN Coated Code No.	SALE \$
1/4	1/4	1-1/8	3	0.005	153-170	23.93	153-434	27.68
5/16	5/16	1-1/8	3	0.005	153-172	26.70	153-436	34.13
3/8	3/8	1-1/8	3	0.005	153-174	37.88	153-438	43.28
1/2	1/2	1-1/2	4	0.005	153-176	57.08	153-440	67.05
1/2	1/2	2	4	0.005	153-178	57.08	153-442	67.05
5/8	5/8	2-1/4	5	0.005	153-180	109.05	153-444	128.70
3/4	3/4	2-1/4	5	0.005	153-182	161.03	153-446	183.68
1	1	2-1/4	5	0.005	153-184	247.65	153-448	267.45

Visit the

**SOWA
CLEARANCE
CENTRE**

up to 50% off

www.sowatool.com

Distributed by:



MORSE TAPER SLEEVES

• Hardened & ground throughout

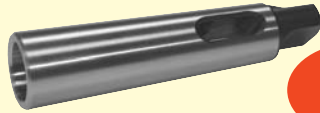

**SAVE
15%**

Sleeve No.	Morse Taper Hole	Morse Taper Outside	Overall Length	Code No.	SALE \$
23	2	3	4-3/8	420-315	4.93
34	3	4	5-1/2	420-330	5.36
35	3	5	6-1/8	420-345	11.56
45	4	5	6-3/4	420-350	11.56
46	4	6	8-5/8	420-355	20.57



BISON AMERICAN TONGUE & GROOVE JAWS FOR 3-JAW CHUCKS

**SAVE
15%**

• Sold Individually

Chuck Dia.	Code #	SALE \$
8	465-115	28.39
10	465-120	41.31
12	465-125	56.02
16	465-130	76.50



SCLCR BORING BAR KIT



x 10

Consists of:

- 1 - SI-SCLCR 16-3 (1") Boring Bar (145-927)
- 10 - CCMT 32.51 F2P PT20C Inserts (146-470)

Code No. 149-875

\$117.00



PART OFF BLADE KIT

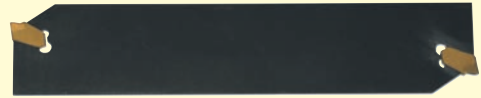

x 10

Consists of:

- 1 - PP-B 326S 1" Part Off Blade (146-898)
- 10 - SP300 PT30C Inserts (146-452)
- 1 - SW15S Wrench (146-771)

Code No. 149-836

\$189.60



PROMO E NOGA SET

NG8150

For Steel, Aluminum & Plastic
Contains: Noga Grip handle & 10pcs S10 (E100) blades

Code No. 165-464

\$17.51



ECONOMY NOGA SET

NG8050

For Steel, Aluminum & Plastic
Contains: Noga Grip handle & 20pcs N1 (B10) blades

Code No. 165-478

\$24.40



B10 BLADE

For Steel, Plastic and Aluminum
Fits tools 165-010 & 165-310
Standard pack 10pcs

Code No. 165-320

\$1.36 per blade



VAT 712 MINI ARM TYPE AIR TAPPING UNIT

- Air tapping spindle
- Parallel arm
- Table mounting column
- Air combination
- 6 ANSI Tap Collets
- Radial jib
- Without stand plate
- Air pressure: 6~8 kgs/cm³
- Requires: 5HP compressor

Tap Range	#10 - 1/2
Speed RPM	400
Weight (kgs)	12
Work Range	Rmax 700mm

Code No. 326-700

\$2,484.00

Regular List \$3,081.71

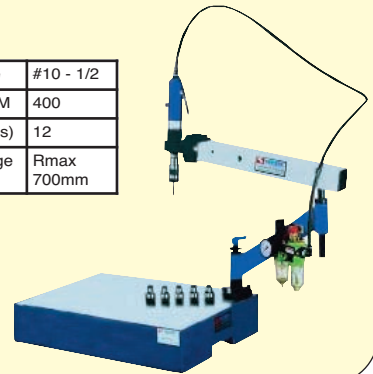

NOGA MAG BASE & INDICATOR COMBO

- Standard Holder DG1033 165-350
- 0 - 0.4, .0005 coolant proof indicator 200-075

Holder features:

- 11" reach
- Powerful On/Off magnetic base (80kg/f)

Indicator features

- Water resistant
- Reverse counter
- Lugback (1/4" hole)
- AGD2
- Interchangeable point

Promo Code No.

500-228

\$168.52

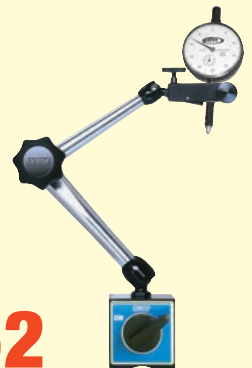



Rohm Live Centres

STANDARD LIVE CENTRES 60° TYPE 600

Morse Taper.	Max Workpiece Weight kg.	Max. RPM	A (mm)	B (mm)	D (mm)	G (mm)	K (mm)	Code No.	SALE \$
2	200	7000	62	32	15	17.780	18	392-410	297.93
4	800	6300	75.5	42	20	31.267	25	392-425	397.55
5	1600	4300	104	58	30	44.399	34	392-430	572.65
6	3500	3000	143	80	42	63.348	49	392-435	1,277.81

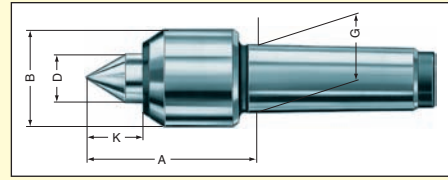

HARDENED AND GROUND LIVE CENTRES 60° TYPE 604 H

Morse Taper.	Max Workpiece Weight kg.	Max. RPM	A (mm)	B (mm)	D (mm)	G (mm)	K (mm)	Code No.	SALE \$
2	200	7000	65	45	20	17.780	24	392-470	399.84
4	800	3800	102.5	70	32	31.267	41	392-490	598.40
5	2000	3000	129	90	40	44.399	50.5	392-500	741.12
6	4500	1500	196	140	60	63.348	67	392-520	2,908.19

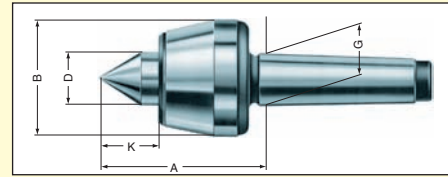

**SAVE
15%**

EXTENDED LIVE CENTRES 60° TYPE 604 HVL

Morse Taper.	Max Workpiece Weight kg.	Maximum RPM	A (mm)	B (mm)	D (mm)	G (mm)	J (mm)	K (mm)	Code No.	SALE \$
4	500	3800	114.5	70	32	31.267	14	53	392-580	615.40
5	1200	3000	143.5	90	40	44.399	16	65	392-585	942.06

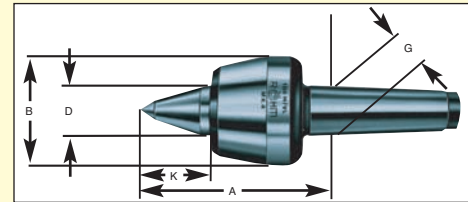

EXTENDED LIVE CENTRES 60° TYPE 600-20

Morse Taper.	Rohm Id No.	Max Workpiece Weight kg.	Max Concentricity Error (mm)	Maximum RPM	A (mm)	B (mm)	D (mm)	G (mm)	J (mm)	K (mm)	Code No.	SALE \$
3	362081	340	0.008	7000	74	34	15	23.825	11	30	392-445	404.94
4	362082	700	0.008	6300	88.5	42	20	31.237	13	38	392-450	494.70
5	362083	1400	0.01	4300	119	58	30	44.399	14	49	392-455	820.51

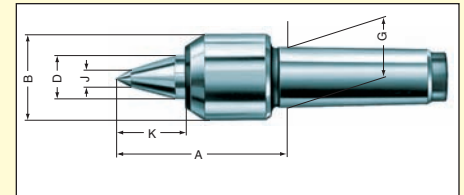

Ball Bearing & Plain Bearing Drill Chucks

BALL BEARING DRILL CHUCK

- Bodies and jaws hardened and ground
- One piece gear/scroll ring eliminates loss of clamping torque
- Dependable and accurate performance
- Ease of operation
- Extended life

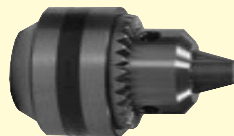

Rohm Id. Nr.	Capacity (In.)	Chuck Mount	Chuck Key	O.D. (In.)	Opened Length (In.)	Closed Length (In.)	Code No.	SALE \$
215001	1/32-5/8	JT3	S10	2.44	3.15	3.94	390-250	167.37
215002	3/16-3/4	JT4	S13	2.80	3.82	4.65	390-255	243.02

ROHM PRIMA KEY TYPE

- Offers unlimited application in metalworking, on wood or in plastics.
- Well proven on portable electric drills, air drills, bench drill or in drill presses, lathes, turret lathes, automatic machinery, etc.
- Prima heavy duty industrial design



Rohm Id. Nr.	Capacity (in.)	Chuck Mount	Chuck Key	O.D. mm	Opened Length (mm)	Closed Length (mm)	Code No.	SALE \$
072818	1/32-1/2	JT6	S3	52	67.5	86	390-165	102.34
072827	1/32-5/8	JT3	S3	56.5	79	98	390-200	129.88
072833	3/16-3/4	JT3	S4	65	82.5	103.5	390-230	212.16



CARBIDE TIPPED DEAD LATHE CENTRE

- Carbide tipped
- With Morse Taper
- 60° included angle
- Precision made
- Hardened and ground



Morse Taper	Length	Code #	Price \$
5	7-7/8	420-925	133.50



BISON DEAD LATHE CENTRE

**SAVE
15%**



Morse Taper	Length	Code #	SALE \$
3	4.92"	889-616	28.56

ASIMETO

PRECISION TOOLS

VALUE +

- European Engineering and Design
- Supplied with nationally traceable calibration certificates
- 12 + 12 Care Warranty Program

12" Optical Comparator

Features

- With 2 dial indicators (1" and 2" travel)
- Large 12" x 13" t-slot stage with 6" horizontal and 2-1/2" vertical travel
- 12" 1 quadrant protractor screen
- Rotatable screen with fine adjustment
- 5 minutes vernier
- Overlay clips
- Exclusive high and low intensity profile illumination switch

New Product!
Limited Supply

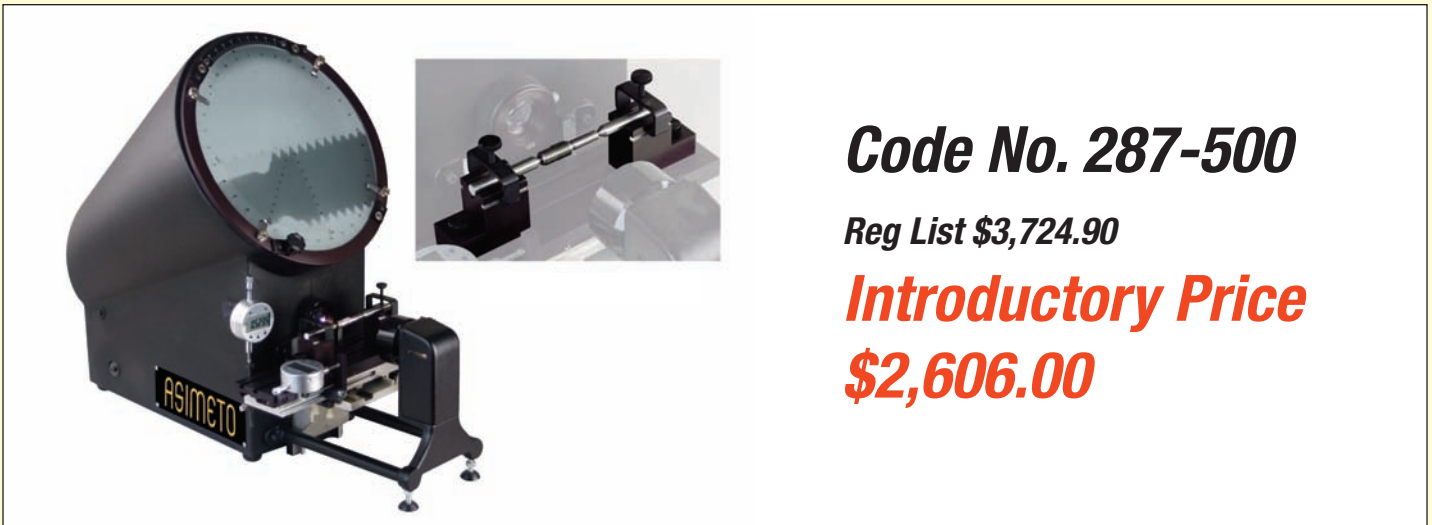

Code No. 287-500

Reg List \$3,724.90

Introductory Price
\$2,606.00



24" DIGIMATIC CALIPER

- Inch/metric conversion
- Auto on, auto shutoff
- .0005"/.01mm resolution
- Zero button



Code No. 200-648
Regular List \$408.00

\$383.44



5-TON ARBOR PRESS

- Throat depth 8-3/4"
- Height of press 35-3/4"
- Base dimensions 10" x 26-3/4"
- Largest arbor 3-1/4"
- Stroke 18-1/8"

Code No. 326-098
Regular List \$1,434.00

\$1,218.90



ASIMETO

Height Gauge & Indicator Combo's

Free Black Book with Height Gauge Combo Purchase!

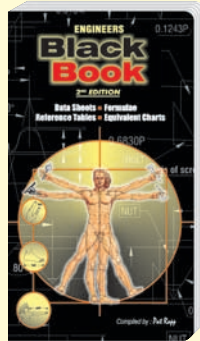

12" Dial/Digital Height Gauge Combo

- 0-12 .001 Dial/digital height gauge 287-100
- 0-15-0 .0005 Grad .03 Range Indicator 287-154
- Holding Bar & Clamp

- Height Gauge Features:
- Dial & digital counter reading
 - Hand wheel for easier travel
 - Carbide tipped scriber

- Test Indicator Features
- Jeweled bearings
 - 5/32 & 3/8 dovetail stems included



\$398.40

Code # 500-147

18" Dial/Digital Height Gauge Combo

- 0-18 .001 Dial/digital height gauge 287-102
- 0-15-0 .0005 Grad .03 Range Indicator 287-154
- Holding Bar & Clamp

- Height Gauge Features:
- Dial & digital counter reading
 - Hand wheel for easier travel
 - Carbide tipped scriber

- Test Indicator Features
- Jeweled bearings
 - 5/32 & 3/8 dovetail stems included



\$570.15

Code # 500-148

12"/300mm Digimatic Height Gauge Combo

- 0-12"/300mm Digimatic Height Gauge 287-131
- 0-15-0 .0005 Grad .03 Range Indicator 287-154
- Holding Bar & Clamp

- Height Gauge Features:
- Fine Adjustment
 - Easy to read large LCD display
 - Inch/Metric conversion
 - SR44 (silver oxide cell) battery

- Test Indicator Features
- Jeweled bearings
 - 5/32 & 3/8 dovetail stems included



\$435.60

Code # 500-150

24"/600mm Digimatic Height Gauge Combo

- 0-24"/600mm Digimatic Height Gauge 287-132
- 0-15-0 .0005 Grad .03 Range Indicator 287-154
- Holding Bar & Clamp

- Height Gauge Features:
- Fine Adjustment
 - Easy to read large LCD display
 - Inch/Metric conversion
 - SR44 (silver oxide cell) battery

- Test Indicator Features
- Jeweled bearings
 - 5/32 & 3/8 dovetail stems included



\$621.68

Code # 500-151

ASIMETO

0-1" DIGIMATIC OUTSIDE MICROMETER

Features:

- On/Off Sensor
- Extra large LCD readout
- Carbide Faces
- Inch/Metric conversion
- .0001" Accuracy
- Ratchet stop
- SPC output



Code No. 285-040
Regular List \$229.80

\$223.83



GRANITE SURFACE PLATE GRADE A 0-LEDGE

Imported Precision Toolroom Black Granite Surface Plates

These plates are made of the highest quality – True Black – Fine Grained – Non-porous – Jewel Hardness – Granite available to give years of long lasting service.

Specifications:
Compressive Strength 7329 lbs. / sq. inch
Water Absorptivity 0.13%
Weight 475 lbs



24" x 36" x 4"

**SAVE
15%**

Code No. 255-140

\$366.18

MAX DRILL

DEEP HOLE DRILLING SYSTEM

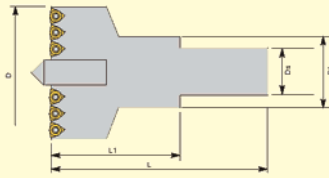

Note: Drill head complete with cartridges - Pilot Drill not included

VMD MAX DRILL - MX MODULAR SHANK TYPE

Model No.	D (in.)	Ds (mm)	D1 (mm)	L1 (mm)	L (mm)	Pilot Drill	Cartridge	Code No.	Price \$
VMD-045050	1.77-1.97	13	28	50	85	PLD-1035	VMC-045050N/T	156-000	737.30
VMD-050055	1.97-2.17	13	28	50	85	PLD-1035	VMC-050055N/T	156-002	790.00
VMD-055060	2.17-2.36	16	32	60	100	PLD-1238	VMC-055060N/T	156-004	842.60
VMD-060065	2.36-2.56	16	32	60	100	PLD-1238	VMC-060065N/T	156-006	987.40
VMD-065070	2.56-2.76	16	32	60	100	PLD-1238	VMC-065070N/T	156-008	1,053.20
VMD-070075	2.76-2.95	22	40	70	115	PLD-1645	VMC-070075N/T	156-010	1,053.20
VMD-075080	2.95-3.15	22	40	70	115	PLD-1645	VMC-075080N/T	156-012	1,097.10
VMD-080085	3.15-3.35	22	40	70	115	PLD-1645	VMC-080085N/T	156-014	1,162.90
VMD-085090	3.35-3.54	27	48	70	120	PLD-1645	VMC-085090N/T	156-016	1,162.90
VMD-090095	3.54-3.74	27	48	70	120	PLD-1645	VMC-090095N/T	156-018	1,162.90
VMD-095100	3.74-3.94	27	48	70	120	PLD-1645	VMC-095100N/T	156-020	1,250.70
VMD-100105	3.94-4.13	32	58	80	130	PLD-2045	VMC-100105N/T	156-022	1,250.70
VMD-105110	4.13-4.33	32	58	80	130	PLD-2045	VMC-105110N/T	156-024	1,250.70
VMD-110115	4.33-4.53	32	58	80	130	PLD-2045	VMC-110115N/T	156-026	1,250.70
VMD-115120	4.53-4.72	40	70	90	145	PLD-2045	VMC-115120N/T	156-028	1,492.00
VMD-120125	4.72-4.92	40	70	90	145	PLD-2556	VMC-120125N/T	156-030	1,667.60
VMD-125130	4.92-5.12	40	70	90	145	PLD-2556	VMC-125130N/T	156-032	1,667.60
VMD-130135	5.12-5.32	40	70	90	145	PLD-2556	VMC-130135N/T	156-034	1,667.60
VMD-135140	5.32-5.51	40	70	90	145	PLD-2556	VMC-135140N/T	156-036	1,667.60
VMD-140150	5.51-5.91	50	80	100	160	PLD-2556	VMC-140150N/T	156-038	2,018.60
VMD-150160	5.91-6.30	50	80	100	160	PLD-2556	VMC150160N/T	156-040	2,018.60
VMD-160170	6.30-6.69	50	80	100	160	PLD-3068	VMC-160170N/T	156-042	2,062.50
VMD-170180	6.69-7.09	50	80	100	160	PLD-3068	VMC-170180N/T	156-043	2,632.90

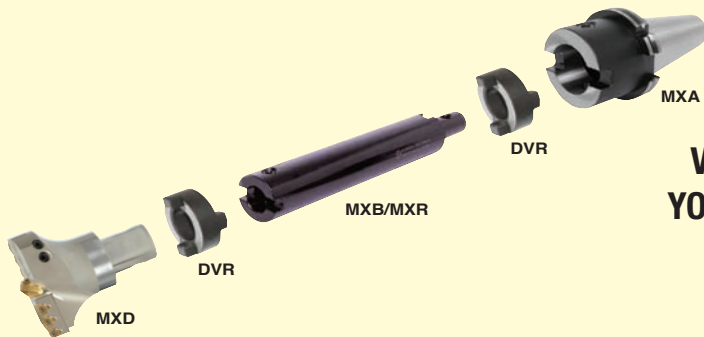

VISIT OUR WEBSITE TODAY TO GET
YOUR COPY OF THE MAX DRILL FLYER
www.sowatool.com



CARBIDE ROUGHERS TYPHOON COATED

This fine pitch rougher is designed for milling harder metals and has updated geometry for higher feed rates with no vibration or chatter and chipbreakers to eliminate birdnesting.

**SAVE
25%**



Cutting Diameter (in.)	Shank Diameter (in.)	Flute Length (in.)	Overall Length (in.)	No. Flutes	Code No.	SALE \$
1/4	1/4	3/4	2-1/2	3	104-800	28.58
5/16	5/16	3/4	2-1/2	3	104-802	39.90
3/8	3/8	7/8	2-1/2	3	104-804	47.18
1/2	1/2	1	3	4	104-806	75.23
5/8	5/8	1-1/4	3-1/2	4	104-810	137.10
3/4	3/4	1-5/8	4	4	104-812	193.88
1	1	1-3/4	4	5	104-814	255.30



5 PIECE CT 18"-30" SWING QUICK CHANGE TOOLPOST SET

Set Includes:

- 1 piece toolpost
- 3 piece "D" holders
- 1 piece "B" holder

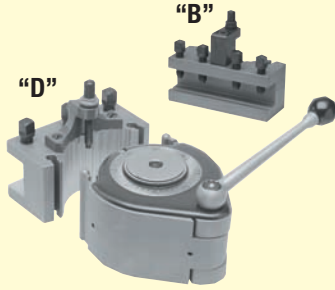

Code No. 388-420

Regular List \$1,780.60

\$1,068.00



TOUCH POINT SENSOR (WITH BEEPER)

- Model No. VPS-3/4B
- Accuracy: within 0.005mm
- 3/4" shank



Code No. 337-962

\$123.85



0-1" AGD2 DIAL INDICATOR

- Reverse counter
- Stainless Steel components
- Interchangeable point
- Rotating bezel with clamp
- Lugback (1/4" hole)



Travel (in)	Dial (in)	Grad. (in)	Code No.	SALE \$
1	0-50-100	.0005	200-755	19.47



40 TAPER TOOL LOCK

- For CAT, BT & NMTB tapers

\$168.64



Code No. 335-275

Regular List \$198.40



50 TAPER TOOL LOCK

- For CAT, BT & NMTB tapers

\$168.64



Code No. 335-280

Regular List \$198.40



TOUCH POINT SENSOR

- Model No. VPS-20
- 20mm shank

\$88.23



Code No. 337-955

Regular List \$103.80



HEIGHT PRESETTER - OPTICAL TYPE

- Model No. HP-50Z
- Height 50 mm
- Accuracy 0.005 mm
- Weight: 0.3 kg

Code No. 337-971

\$135.00



8" D1-3 TYPE 333 3-JAW CHUCK

- Rohm Id. No. 106354
- Cast Iron body
- 51.2mm through hole

Code No. 389-451

Regular List \$2,818.20



\$1,409.00

Includes:

- Set of master base and top reversible jaws



One Only

10" TYPE 300 3-JAW CHUCK

- Rohm Id. No. 100200
- Cast Iron body
- Cylindrical centre mount (plain back)
- 76mm through hole

Includes:

- 1 set of outward stepped jaws mounted on the chuck
- 1 set of inward jaws
- 1 operating key, mounting bolts

Code No. 399-997

Regular List \$1,943.60



\$728.85



One Only



BIMETAL M42 BANDSAW BLADES

Dimensions

- 13'6" x 1 x .035"
- 2-3 tpi
- Positive rake



Code No. 657-430

Regular List \$79.60

\$39.80



115 PIECE 3-IN-1 FORGED DRILL SET C/W CASE

Includes:

- 1/16 - 1/2" by 64ths
- Letter A - Z
- Wire Gauge 1 - 60
- Metal case

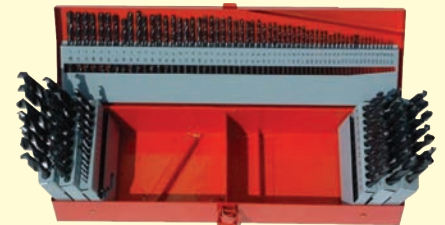

Code No. 119-670

Regular List \$124.50

\$60.00

* While supplies last



2 Flute Solid Carbide Drill Mills

- Drill/Mills can be used for drilling, slotting, profile milling
- 2 Flute - 60° & 90° included point angle
- Made from submicron grain carbide
- Cutting Diameter tolerance: +.000/- .002



SPECIAL NET PRICING!!



Cutting Dia. (in.)	Shank Dia. (in.)	Flute Length (in.)	Overall Length (in.)	60° Code No.	SALE \$	90° Code No.	SALE \$
1/16	1/8	3/16	1-1/2	153-187	12.15	153-186	11.55
3/32	1/8	3/8	1-1/2	153-189	12.15	153-188	11.55
1/8	1/8	1/2	1-1/2	153-191	11.33	153-190	11.33
3/16	3/16	5/8	2	153-193	16.13	153-192	16.13
1/4	1/4	3/4	2-1/2	153-195	20.63	153-194	20.63
5/16	5/16	13/16	2-1/2	153-197	20.63	153-196	20.63
3/8	3/8	1	2-1/2	153-199	32.48	153-198	32.48
7/16	7/16	1	2-3/4	153-201	44.18	153-200	42.53
1/2	1/2	1	3	153-203	53.63	153-202	53.63
5/8	5/8	1-1/4	3-1/2	153-205	103.43	153-204	99.38
3/4	3/4	1-1/2	4	153-207	152.48	153-206	146.70

FX16 FIXED RIGHT ANGLE HEADS

- Endmill & Drill Size Cap. 16mm
- Tap Size Cap. M12
- Weight: 40 Taper 7.7kg
- R.P.M. - 5,000
- 50 Taper 11.7kg



FX16 ER25

Taper	Code No.	SALE \$
CAT 40	384-100	8,104.50
CAT 50	384-102	8,810.42

PV13 PIVOTING RIGHT ANGLE HEAD

- Endmill & Drill Size Cap. 13mm
- Tap Size Cap. M10
- Weight: 7.8kg
- R.P.M. - 3,000



PV13 ER20

Taper	Code No.	SALE \$
CAT 40	384-198	8,230.64

PV20 PIVOTING RIGHT ANGLE HEAD

- Endmill & Drill Size Cap. 20mm
- Tap Size Cap. M16
- Weight: 18.5kg
- R.P.M. - 2,500



PV20 ER32

Taper	Code No.	SALE \$
CAT 50	384-150	12,023.25



TP-1104 5" EXTENDED H.D. DIE GRINDER

Horse Power: 0.3 hp
Free Speed (R.P.M.): 25,000
Collet Size: 1/4" or 6mm

Code No.: 174-032

Sale Price: \$125.09



SAVE
30%

TP-1101H 1/4" DIE GRINDER

Horse Power: 0.3 hp
Free Speed (R.P.M.): 28,000
Collet Size: 1/4" or 6mm

Code No.: 174-038

Sale Price: \$65.87



TP-1106H 1/4" RIGHT ANGLE DIE GRINDER

Horse Power: 0.3 hp
Free Speed (R.P.M.): 20,000
Collet Size: 1/4" or 6mm

Code No.: 174-046

Sale Price: \$104.51



Pricing in effect from January 1 to March 31 2012 or while quantities last



Sowa Tool & Machine Co. Ltd.
500 Manitou Drive
Kitchener, Ontario
N2G 4B6

Western Canada Branch
9649-49th Ave
Edmonton, AB
T6E 5Z5

Toll Free: 1-800-265-8221
Phone: (519) 748-5750
Fax: (519) 748-9304
Email: sales@sowatool.com
web: www.sowatool.com



* C A D I S 1 7 *